

# O2 NOW PANEL SYSTEM

- [2] 6'X5'6"X67"H NON-POWERED STATIONS WITH OVERHEAD STORAGE UNIT  
OPEN SHELF AND BBF/FF PEDESTAL
- [1] MOBILE COMPUTER CART

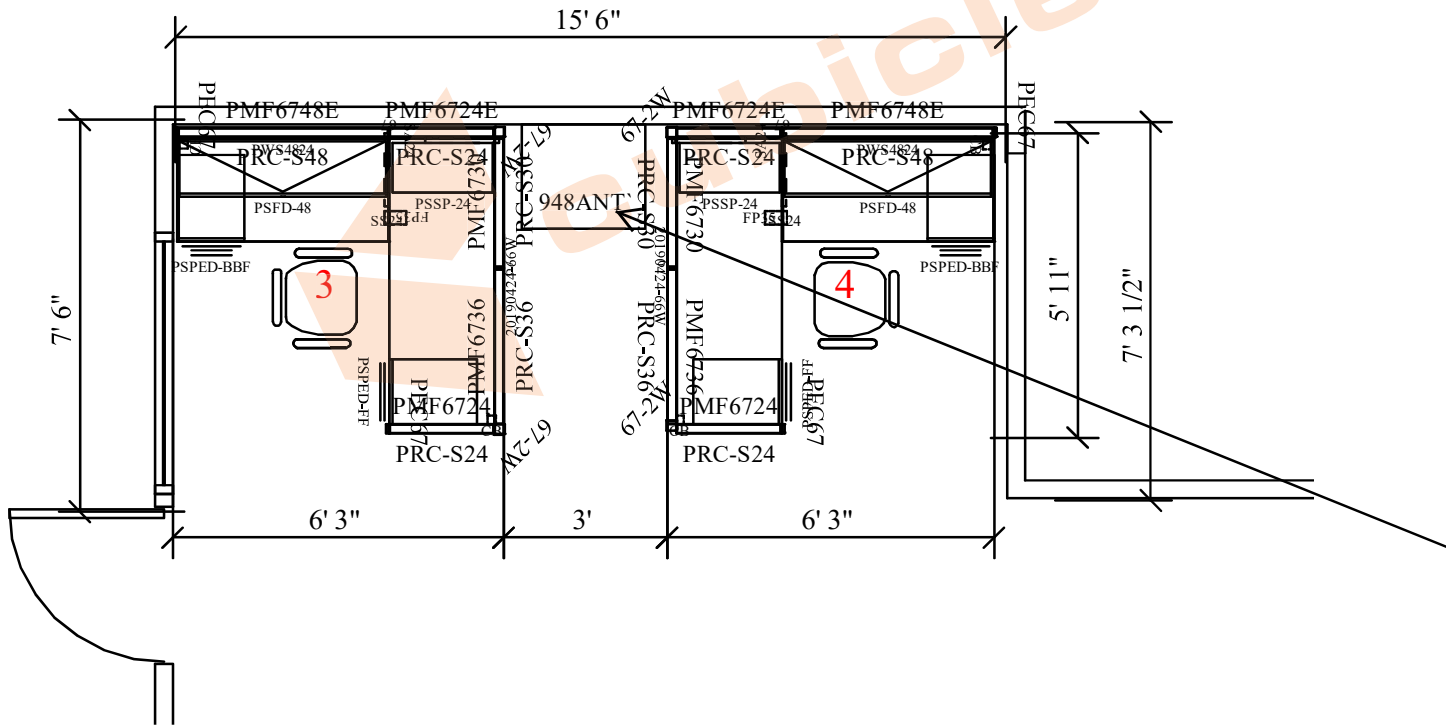

## PREMIUM HOSPICE - SECTION 2



\* SEATING AVAILABLE UPON REQUEST

IMAGE FOR REFERENCE ONLY

# SPECIAL T HEIGHT ADJUSTABLE

- [1] 5'X5' HEIGHT ADJUSTABLE DESK WITH MOBILE BBF PEDESTAL MODESTY PANEL, POWER HUB AND DUAL MONITOR ARM
- [1] 2'X4' HEIGHT ADJUSTABLE DESK WITH DUAL MONITOR ARM AND
- [1] MOBILE BBF PEDESTAL



## ADMIN OFFICE - MAGZ

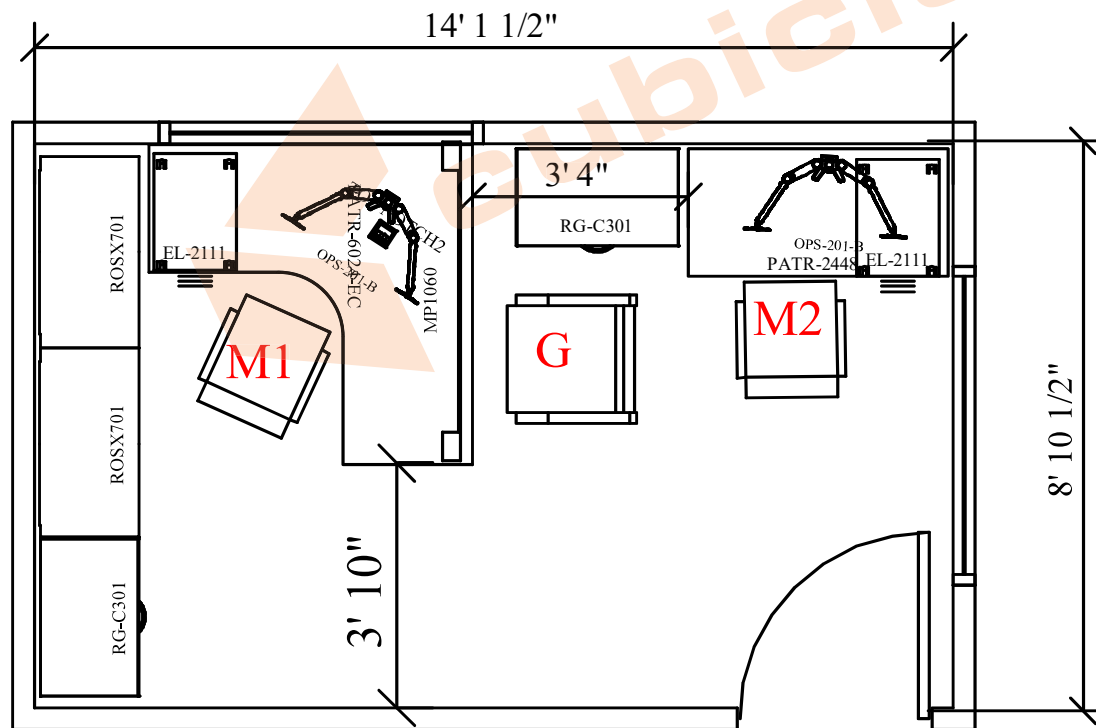

IMAGE FOR REFERENCE ONLY

## SPECIAL T HEIGHT ADJUSTABLE DESKS

[1] 6'X6' HEIGHT ADJUSTABLE DESK WITH MOBILE BBF PEDESTAL  
MODESTY PANEL, POWER HUB AND DUAL MONITOR ARM

\* SEATING AVAILABLE UPON REQUEST



## HOME HEALTH JAY

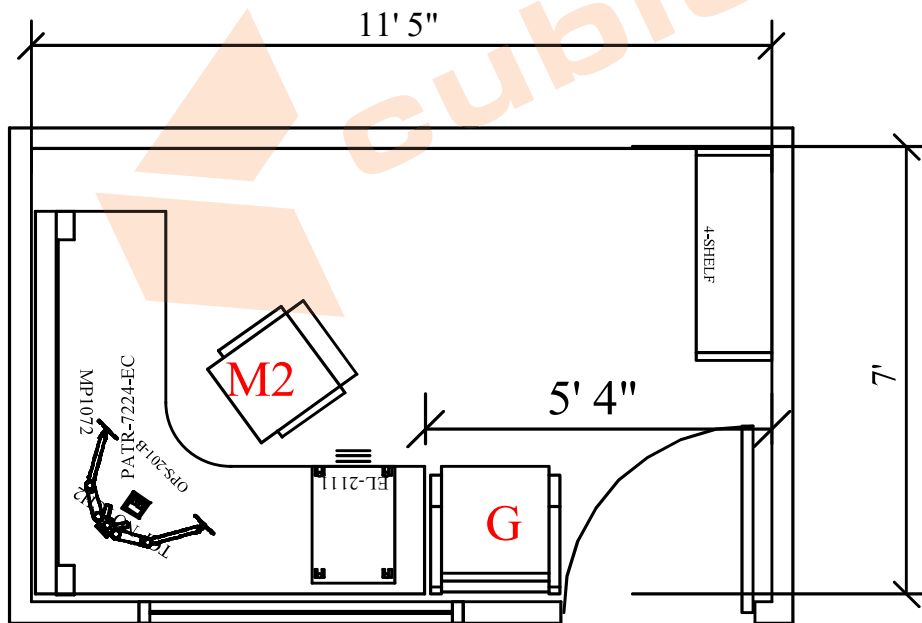

IMAGE FOR REFERENCE ONLY

# SPECIAL T HEIGHT ADJUSTABLE DESKS

[1] 6'X6' HEIGHT ADJUSTABLE DESK WITH MOBILE BBF PEDESTAL



## HOSPICE MEGAN

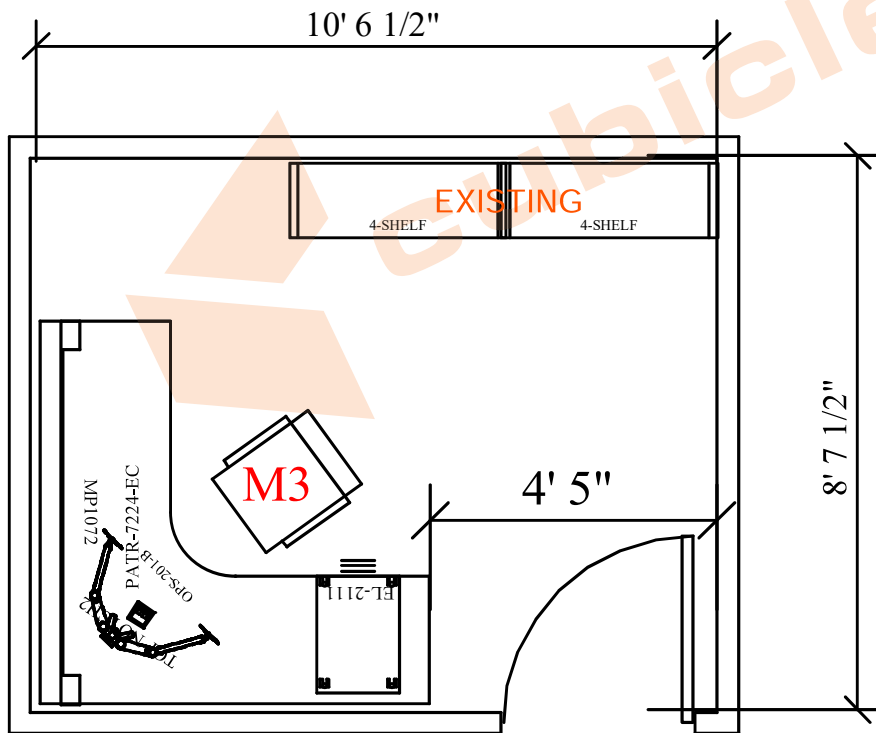

IMAGE FOR REFERENCE ONLY

\* SEATING AVAILABLE UPON REQUEST

# CHERRYMAN DESKS

[2] 2'6"X6' DESK WITH BBF PEDESTAL  
AND DUAL MONITOR ARM

## MOM

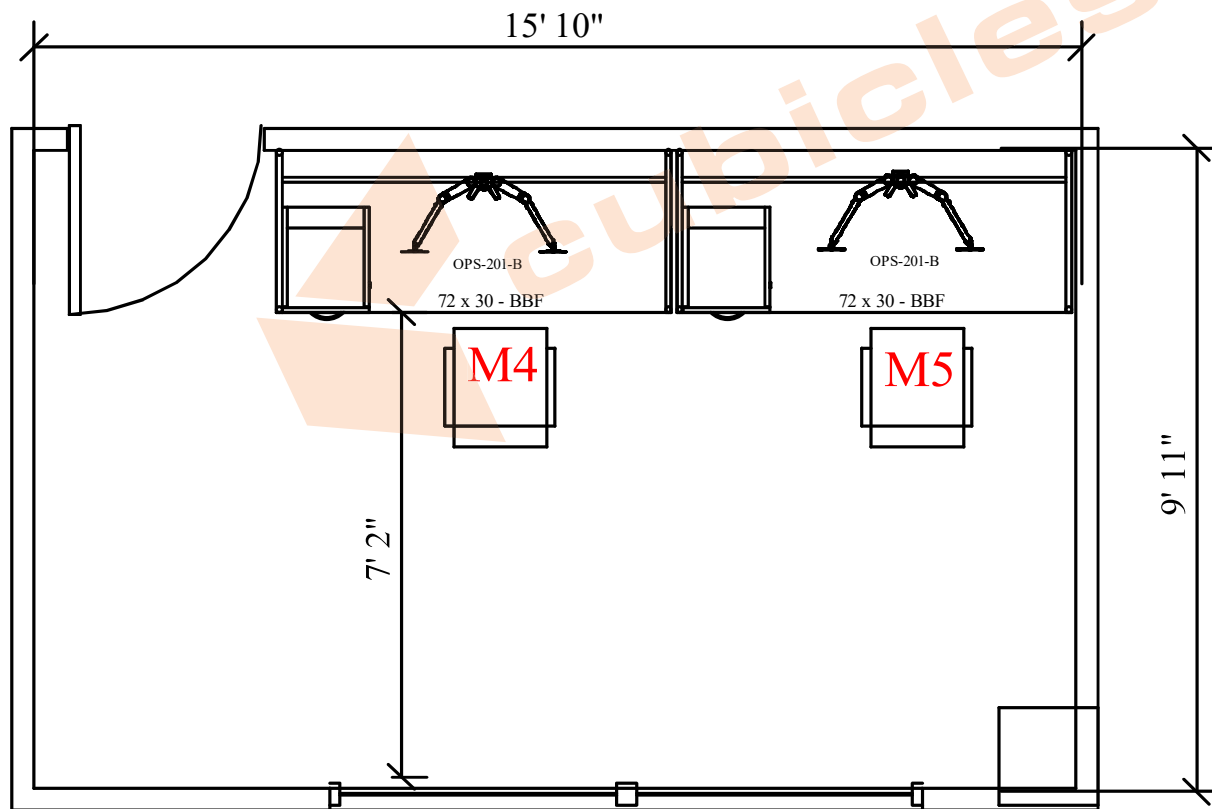

IMAGE FOR REFERENCE ONLY

\* SEATING AVAILABLE UPON REQUEST